

# EUROKA CEMETERY MANAGEMENT PLAN



**Euroka Road, Euroka**

**Adopted by Council  
9<sup>th</sup> January 2001**

## TABLE OF CONTENTS

<b>1</b>	<b>Introduction</b>	<b>4</b>
1.1	Background	4
1.2	Where this plan applies	4
1.2.1	Regional Location Map	4
1.2.2	Plan of the Cemetery	5
1.3	Previous Planning Strategies	5
1.4	Summary of History of the Cemetery	5
<b>2</b>	<b>Current Practices and Services</b>	<b>6</b>
2.1	Horticultural Maintenance	6
2.1.1	Mowing	6
2.1.2	Control of Weeds and Problem Species	6
2.2	Rubbish Removal	6
2.3	Water Supply	6
2.4	Power Supply	6
<b>3</b>	<b>Human Resources</b>	<b>7</b>
3.1	Current Management Structure	7
3.2	Future Management Structure	7
<b>4</b>	<b>Finance</b>	<b>8</b>
4.1	Financial Resources	8
4.1.1	Direct Allocation	8
4.1.2	State Government Allocation	8
4.1.3	Grants and Loans	8
4.1.4	Sponsorship / Donations	8
4.1.5	Merchandising	8
4.1.6	Burial Fees and Other Fees for Services	9
<b>5</b>	<b>Community Needs and Expectations</b>	<b>9</b>
5.1	Visitor Profile	9
<b>6</b>	<b>Euroka Cemetery Assets</b>	<b>9</b>
6.1	Current Assets	9
6.2	Future Assets	9
<b>7</b>	<b>Risk Management and Insurance</b>	<b>10</b>
7.1	Public Safety	10
7.2	Occupational Health and Safety	10
7.3	Insurance Cover	11
<b>8</b>	<b>Monitoring and Review</b>	<b>11</b>

9	Photographs of Euroka Cemetery	12
10	Cemetery Asset Management Program	13
11	Appendices	19
12	Glossary of Terms	22



***Euroka Church that once formed a part of the Cemetery.***

## 1.0 INTRODUCTION

### 1.1 Background

The Euroka Cemetery is located on a hill that over looks the floodplain of Euroka and the Macleay River to Greenhills in the North.

The Euroka Cemetery is of local significance the Uniting / Methodist Community of the Shire. The church was set in an area of large Uniting / Methodist faith, and the cemetery was within its grounds originally. No other cemetery in the Kempsey Shire controlled by Council has this history.

### 1.2 Where this Plan Applies

Euroka Cemetery is located at Lot 11 DP816589, Euroka Road, Euroka, Parish of Kalateenee, County of Dudley and is 2480sqm (LA.15609)

#### 1.2.1 Regional Location Map

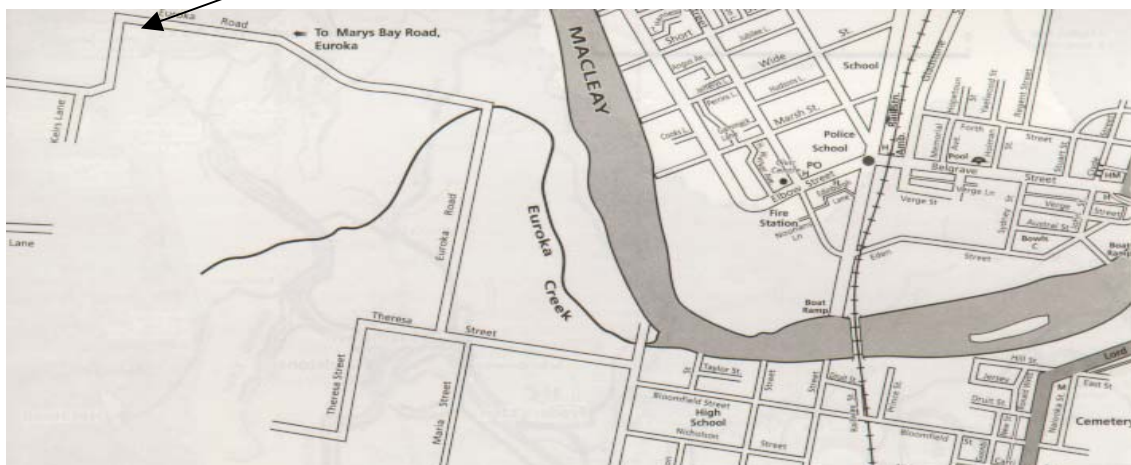
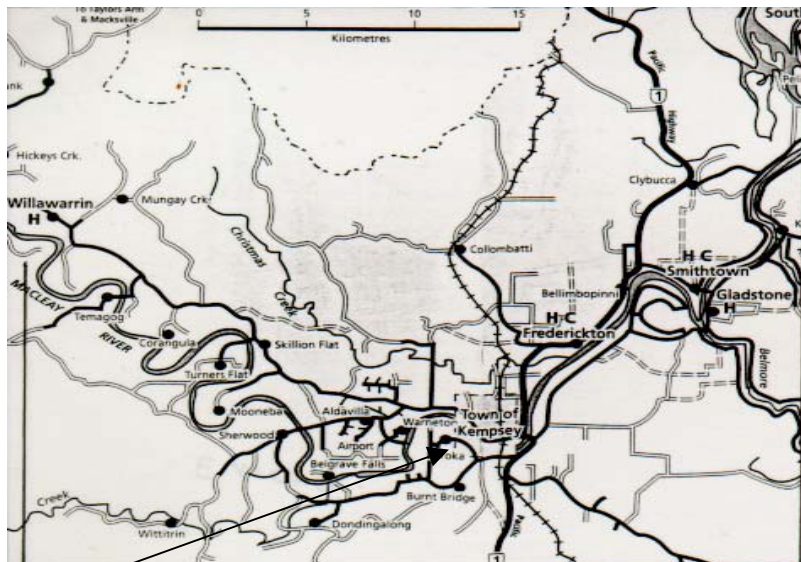

## 1.2.2 Plan of the Cemetery

Current Map of the Cemetery

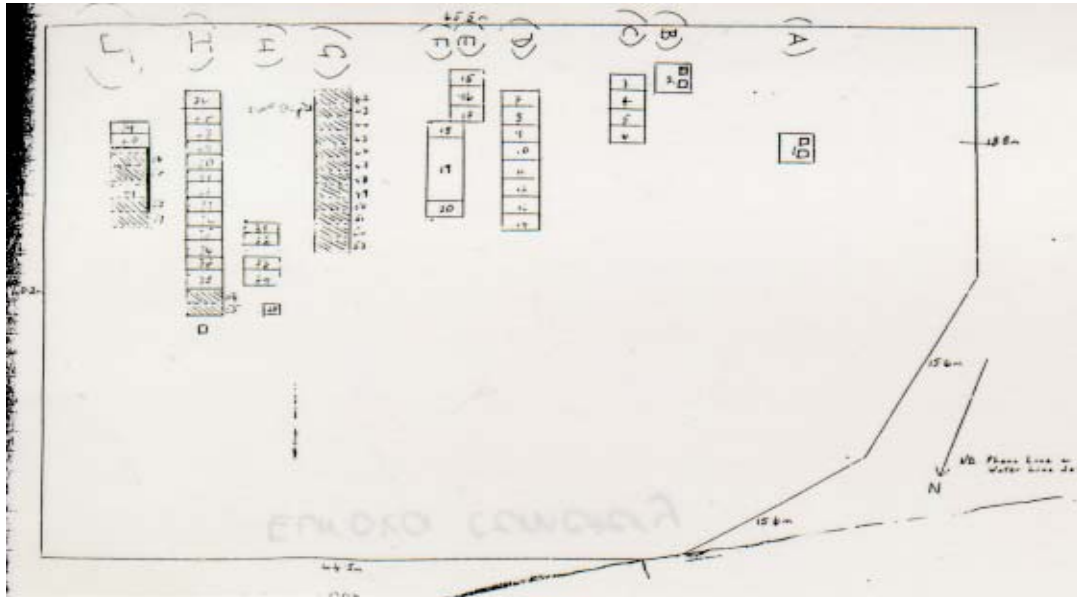

## 1.3 Previous Planning Strategies

18 March 1997	DCP No 24 – Access and Mobility
16 June 1998	DCP No 25 – Advertising Signs in Kempsey Shire.
21 June 1998	DCP No 28 – Leasing of Public areas for Restaurants and Cafes
21 June 1998	DCP No 29 – Bed and Breakfast Accommodation.
29 July 1988	Amendment No 1
12 August 1988	Amendment No 4
26 May 1989	Amendment No 11
2 August 1991	Amendment No 17
24 December 1993	Amendment No 35
23 May 1994 –	Classified – Community Land LGA Sch762 (c) Sec 94 CC 92/1524 Minute No 1.20550
1 July 1993	Plan of Management – Cemetery
1 August 1995	CE

## 1.4 Summary of History of the Cemetery

The history of the Eureka Cemetery is chronologised as follows:-

<b>YEAR</b>	<b>EVENT(s)</b>
August 1880	First recorded interment took place.
1992	The Cemetery was subdivided and transferred to Councils control.

## **2.0 CURRENT PRACTICES AND SERVICES**

**Aim:** Councils aim in undertaking maintenance is to control grass and weeds around gravesites. Maintenance of headstones is not part of Councils maintenance regime due to the professional requirements of such an undertaking and Councils limited funding.

### **2.1 Horticultural Maintenance**

#### **2.1.1 Mowing**

Mowing of the cemetery is undertaken at regular intervals by day labour staff

#### **2.1.2 . Control of Weeds and Problem Species**

Weeds are controlled by spraying with a biodegradable herbicide. Graves are also whipper snipped around when mown as part of the maintenance mowing operation.

Weed control is undertaken between September and November each year prior to the growing season.

### **2.2 Rubbish Removal**

Garbage bins are located around the cemetery. The rubbish is removed by the day labour staff at regular intervals and before and after special occasions such as Mothers and Fathers Days, Christmas, Easter and Anzac Days.

### **2.3 Water Supply**

The Euroka Cemetery has the town water supply collected.

### **2.4 Power Supply**

There is no connection to a mains power supply. Energy for lighting, powering of tools and other equipment or use by staff (eg, for boiling water) has to be imported in the form of petrol-driven electricity generators.

### **3.0 HUMAN RESOURCES**

#### **3.1 Current Management Structure**

The current management structure is as follows:-

##### *Community Services Department Staff*

Director Community Services – Operations overview

Community Services Officer – Handles the day to day management of the cemeteries.

##### *Operational Services Department Staff*

Co-ordinator– supervisors day labour staff

Head Gravedigger – Day labour staff

Assistant Gravedigger–Day labour staff

Volunteers help maintain this cemetery also.

#### **3.2 Future Management Structure**

Councils cemeteries are currently being maintained by Day labour staff.

Currently Council maintains eight (8) cemeteries. During the past two summers the gravediggers have had the assistance of an additional employee to assist with the maintenance.

If Council is to increase the level of service at the cemeteries there is a need to look at its human resources.

### **4.0 FINANCE**

#### **4.1 Financial Resources**

An examination of cemetery management's financial reports indicates that income is only sufficient to allow for basic horticultural management with occasional capital works funded. Unless a more substantial funding base is achieved cemetery management cannot hope to further its objectives.

Various options for funding Cemetery services are provided below:-

##### **4.1.1 Direct Allocation**

Kempsey Shire Council funds the continual maintenance of the cemeteries from its annual operating budget. This budget is allocated in July of every year. The 2000 / 2001 operating budget is \$172,100 for all of Councils cemetery services.

##### **4.1.2 State Government Allocation**

Cemeteries which are Crown Reserves or community land may receive recurrent allocations from State government and may be eligible to apply for funds from particular sources.

#### **4.1.3 Grants and Loans**

Governments make grants and loans available from time to time under such schemes as the National Estate Grants Program and the Heritage Assistance Program. In New South Wales, many small cemetery conservation projects have been assisted financially by these means. Outright grants are becoming less common, and most government agencies expect organisations applying for funds to raise a significant proportion of the amount they need, usually at least \$ for \$.

Under some funding schemes, applicants can obtain loans at attractive rates, sometimes with deferred repayments.

The New South Wales Department of Land and Water Conservation administers the Public Reserves Management Fund from which some grants are made available for regular operating costs of some cemeteries which are Crown Reserves, allocated on a recurrent rather than an annual basis.

#### **4.1.4 Sponsorship/Donations**

Relatives of those buried in a cemetery could be approached to assist with the conservation of their forebear's graves. They may also be prepared to donate funds for memorial gardens, walls or seats.

#### **4.1.5 Merchandising**

While the cemetery may not seem to offer many merchandising opportunities, there is scope for the production, for sale, of volumes of biographical information about people in their respective cemeteries, and this is another avenue which may be developed further. Examples from Waverley Councils biographies are linked to themes such as "Crime and Punishment" and "Arts and Literature" and complement guided tours of the cemetery conducted by that Councils' Local History Librarian.

#### **4.1.6 Burial Fees and Other Fees for Services**

Attached at Appendix A is a schedule of fees levied for burials, placement of ashes, administrative fees for monumental works, and other cemeteries services.

### **5.0 COMMUNITY NEEDS AND EXPECTATIONS**

Many cemeteries today can fulfil multiple purposes as places of burial and remembrance, genealogical research and passive recreation. A visitor survey is a useful way that will help to define the needs and expectations the local community has for the cemetery.

#### **5.1 Visitor Profile**

As part of the process of undertaking the Cemetery Management Plan for the Euroka Cemetery a Visitor Survey was produced and advertised extensively in the Shire. A copy of the Survey is attached at Appendix B.

No surveys were received from the community relating to this cemetery.

## **6.0 EUROKA CEMETERY ASSETS**

As part of the plan all of the Cemetery assets have to be quantified and relevant programs implemented for their maintenance and new facilities / assets identified.

### **6.1 Current Assets**

Euroka Cemetery, as previously advised, was dedicated to Councils control in 1992 after the cemetery and the Uniting Church at Euroka was subdivided and sold. The only asset is the land, which was classified Community Land on the 23 May 1994.

### **6.2 Future Assets**

As the Euroka Cemetery is closed to future interment, other than for people with reserves.

The Cemetery Services Asset Management Program for all Council cemeteries is detailed further in Section 10.



**Oldest Headstone in the Cemetery - Mr John & Mrs Elizabeth Booth.**

## **7.0 RISK MANAGEMENT AND INSURANCE**

### **7.1 Public Safety**

Cemetery management and staff are committed to a policy of risk management and public liability minimisation. Regular inspections and monitoring of the site is carried out to identify potential and future risks and hazards. Reports of hazards and incidents are made, and log books of remedial actions taken will be kept. Any identified public safety hazards should be removed and/or appropriate warning signs and barricades erected as soon as possible.

Adequate levels of insurance to cover public liability should be maintained.

### **7.2 Occupational Health and Safety**

Cemetery managers and staff are bound by the provisions of the *Occupational Health and Safety Act 1983* and its Regulations, Codes of Practice and Guidelines. A number of Australian Standards relevant to Occupational Health and Safety are applicable to cemeteries. These include:

*AS 1470 – 1986 – Health and Safety at Work*  
*AS 4204 – 1994 – Headstones and Monuments*  
*AS 1657 – 1985 – Fixed Platforms, Walkways, Stairs and Ladders*  
*AS 2727 – 1984 – Chain-saws – Guide to Safe Working Practices*  
*AS 2726 – 1984 – Chain-saw Safety Requirements*  
*AS 1716 – 1994 – Selection, Use and Maintenance of Respirators*  
*Draft AS 2865 – 1995 Safe Work in Confined Spaces*

Also relevant to cemetery operations are the following:  
*Worksafe Australia Draft Ultra Violet Radiation Standard*  
*New South Wales Manual Handling Regulation – 1991*  
*National Standard NOHSC: 1001 (1990) – Manual Handling*  
*National Code of Practice NHOSC: 2005 (1990) – Manual Handling*

In all works cemetery management and staff comply with the requirements of the *Occupational Health and Safety Act 1983* and Regulations. Where the law requires a licence or permit for the operation of plant and equipment, the head Gravedigger (as a representative of Management must) ensures that all workers operating such plant and equipment have the relevant, current licence or permit. Whether or not a licence or permit is required, cemetery management ensures that all operators have been instructed in the safe and correct use of the plant and equipment, that the plant is stable on the ground, and that it is only operated within legally required distances from powerlines.

Cemetery management, staff, voluntary workers and contractors are made aware of Occupational Health and Safety practices / responsibilities. Regular safety audits for occupational health and safety are also carried out. Necessary safety procedures and measures (eg, OH &S training for staff, and provision of safety equipment) are put in place.

Cemetery employees are made aware of the danger of UV radiation in the outdoor environment of the cemetery. During times of exposure employees are required to be

well protected by clothing appropriate to their particular circumstances. Areas of exposed skin be kept to a minimum and a UV protective cream or lotion applied to exposed areas. Council provides employees required to work in wet weather with appropriate wet weather gear, and ensures that an adequate supply of clean, cool drinking water is available at all times.

### **7.3 Insurance Cover**

Adequate insurance cover should be maintained for the following:

- Public Liability
- Voluntary Workers
- Workers compensation (compulsory)
- Fire and damage to replaceable assets

Necessary monitoring and procedures to minimise health and safety risks to cemetery management, staff and visitors should be carried out, thereby limiting the exposure of the cemetery management authority to litigation. The value of assets should be assessed for insurance purposes and adequate cover for structures and contents maintained. A valuation of conservation works (eg, repairs to vaults) and assets (eg, shed, plant and equipment) should be carried out

## **8.0 MONITORING AND REVIEW**

Plans of management must continue to evolve. While they may be endorsed at a particular point in time, they must include provision for review and updating to allow for the fact that some of the plan's recommended strategies will have been implemented, or because circumstances have changed.

Possible changes relevant to a cemetery include the following:

- changes to the physical environment eg, natural disasters such as a major storm.
- changes to the economic environment eg, reduction in available funding as a result of cuts to grant programs, default on lease;
- changes to the organisational environment eg, abolition or restructuring of the management authority;
- changes to the social environment eg, type of stakeholder, for instance, demise of Friends group;
- changes to the political environment eg, change of government, leading to amended policy directions.

Consequently, the Plan needs to be reviewed and amended as necessary after a period of not more than five years. Cemetery management must also continue to be accountable to the community and should monitor and evaluate the Plan's performance and success in achieving its desired outcomes and strategies.

## 9.0 PHOTOGRAPHS OF EUROKA CEMETERY



Driveway Access off Euroka Road

## **10 CEMETERY ASSET MANAGEMENT PROGRAM**

As part of the Change of Management process the Cemetery Services Section of Council has been asked to implement a staged and prioritised program for the establishment and implementation of the Cemeteries Assets.

Several programs have been established. The different programs are as follows:-

### **Maintenance Programs**

The maintenance program is divided into two different programs. These programs are as follows:-

- The Maintenance Program – 4.x 3 months plan looks at how the cemetery is maintained in any given year and it applicable to all cemeteries under Councils care and control and
- The Maintenance Program – 3 x 1 year plan looks at the cemeteries existing assets and what maintenance of these assets needs to be undertaken. Appropriate request with \$'s are prepared for Council's consideration with the Annual Budget.

Both these programs will ensure the continued maintenance of the current assets.

### **Asset Acquisition Programs**

The Asset Acquisition Program looks at acquiring assets that would benefit the cemeteries. There are two (2) programs that look at acquiring assets and are as follows:-

- Short Term Asset Acquisition Program,- looks at acquiring assets in the immediate future, and
- Long Term Asset Acquisition Program, - looks at acquiring assets in twenty (20) years time taking into consideration any potential growth of services.

These programs are explained further in the following pages.

## **11 APPENDICES**

Appendix A – Burial Fees and Other Fees for Services.

Appendix B – Visitor Survey.

## 12 GLOSSARY OF TERMS

Ashes Garden	A repository where ashes are placed.
Burial	To place deceased body into the ground.
Chronologised	To place in order starting with the first event.
Columbarium Wall	A repository where ashes are placed.
Crown Reserve	A parcel of land that is owned by the State Government of New South Wales and has been given to Council to manage the land.
DCP	Refers to a Development Control Plan that has been placed in by Council.
Gazettal	This is when an item of business is passed into practice by State Government and written notification is given.